

CORNER RECORD

COUNTY OF INYO T. 6N. R. 23E MOB MERIDIAN CALIFORNIA
 CORNER TYPE: GOV'T. CORNER ☒ MEANDER ☐ RANCHO ☐ CONTROL ☐ OTHER ☐
 CORNER IDENTIFICATION - DATE OF VISIT October 21, 1983

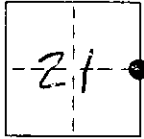

CORNER - LEFT AS FOUND ☒ FOUND AND TAGGED ☐ REESTABLISHED OBLITERATED CORNER ☐ REBUILT ☐

PHYSICAL DESCRIPTION OF CORNER FOUND: EVIDENCE AND METHOD USED TO IDENTIFY OR REESTABLISH Find 1 1/2" IP (OD) with RCE #27104- tag in what appears to be old mound of stone. Pipe is at north edge of old metal post 3.5' high and 2.5' north of a new 4' high fence post. Located 500' north of Caltrans Maintenance Station at Sonora Junction and 400' east of State Highway 395.

PHYSICAL DESCRIPTION OF MONUMENTS REBUILT OR PERPETUATED

CALIFORNIA COORDINATE SYSTEM ORDER: FIRST ☐ SECOND ☐ THIRD ☐

STATIONS USED: NGS (USC & GS) ☐ STATE ☐ COUNTY ☐ OTHER ☐ STATION _____ STATION _____

ZONE _____ ELEVATION _____ NORTHINGS (Y) _____ EASTINGS (X) _____

SKETCH: (Include reference tie or witness points, remarks and topo of area)

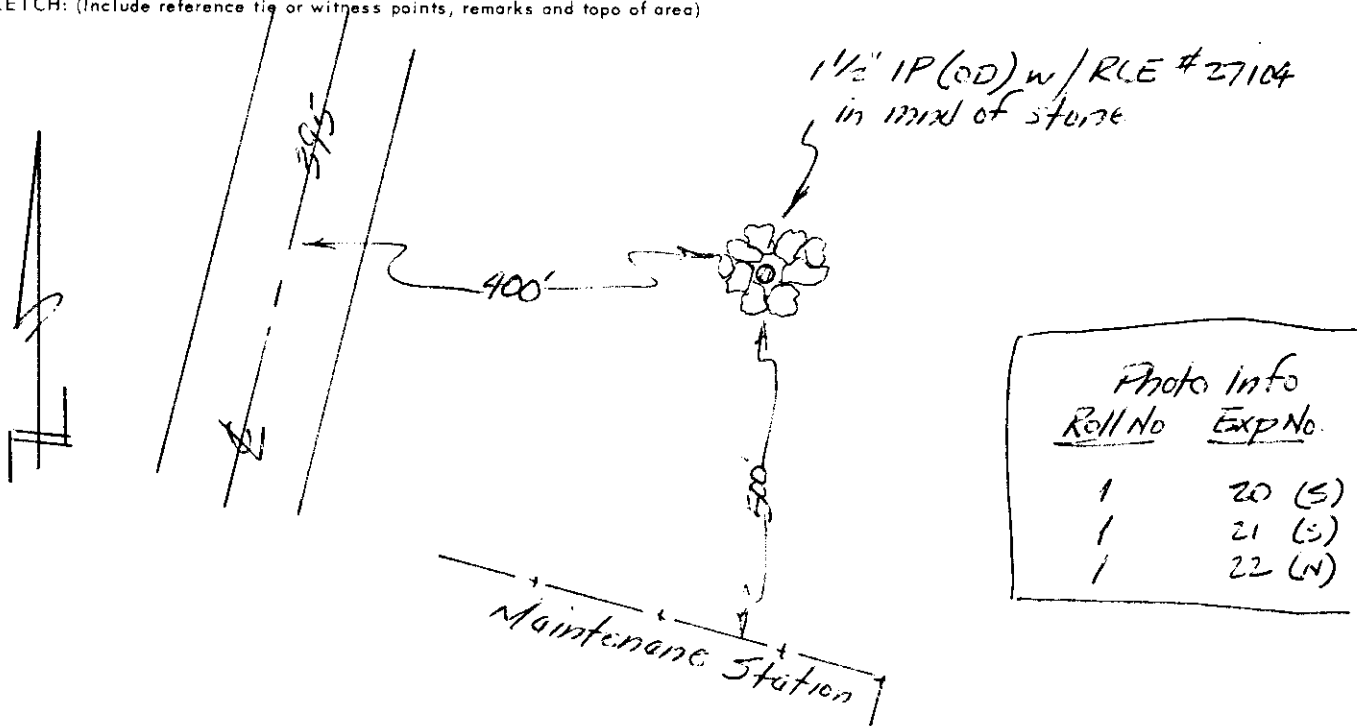

SURVEYOR'S CERTIFICATE

THIS CORNER RECORD WAS PREPARED BY ME OR UNDER MY DIRECTION IN CONFORMANCE WITH THE LAND SURVEYORS ACT ON October 21, 1983

SIGNED: R. R. Ch...

L.S. or R.C.E. No.: Chief of Party - Caltrans

SEAL

COUNTY SURVEYOR'S CERTIFICATE

THIS CORNER RECORD WAS RECEIVED 11-29 1983 AND EXAMINED AND FILED 12-16 1983

BY: Peter Buerdman

TITLE: Deputy County Surveyor

DOCUMENT No. 6N-23-21-4

STATEMENT ON BACK OF SHEET

YES ☒ NO ☐