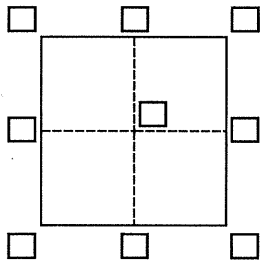

CORNER RECORD

Agency Index

BK 101 PG 8

Document Number

CR 10039City of BERKELEY County of ALAMEDA, CaliforniaBrief Legal Description Found Pin Monument in Well B1473 at Northgate Ave & Quail Ave.**CORNER TYPE**Government Corner ☐Control ☐Meander ☐Property ☒Rancho ☐Other ☐Date of Survey April 18, 2017**COORDINATES (Optional)**N. E. Elevation

Units

Metric ☐U.S. Survey Foot ☐Horizontal Datum Zone Epoch Date Vertical Datum ☐ Complies with Public Resources Code §§8801-8819☐ Complies with Public Resources Code §§8890-8902

PLS Act Ref.:

☐ 8765(d)☒ 8771☐ 8773☐ Other:Corner/
Monument:☐ Left as found☐ Established☐ Rebuilt☒ Pre-Construction☐ Found and tagged☐ Reestablished☐ Referenced☐ Post-Construction

Narrative of corner identified and monument as found, set, reset, replaced, or removed:

☐ See sheet #2 for description(s):**SURVEYOR'S STATEMENT**

This Corner Record was prepared by me or under my direction in conformance with

the Professional Land Surveyors' Act on AUG. 30, 2017

Signed

P.L.S. or R.C.E. No.

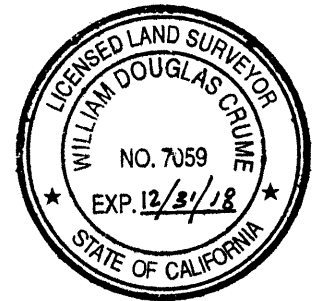
7059**COUNTY SURVEYOR'S STATEMENT**

This Corner Record was received

23 MAY, 2017

and examined and filed

5 SEPTEMBER, 2017

Signed

P.L.S. or R.C.E. No.

6843

Title

COUNTY SURVEYOR

County Surveyor's Comment



